

- Notes:
- 1) Clean and degrease
 - 2) Remove all burrs
 - 3) Tolerances unless stated:
 - 4) Linear $\pm 0.5\text{mm}$, angular 0.25°
 - 5) Surface texture 1.6
 - 6) The 5mm groove machined after the cooling pipes have been soldered onto tube

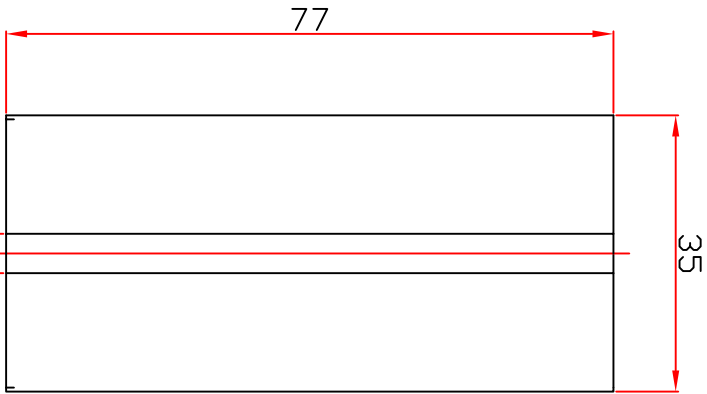

COPPER TUBE
 $\varnothing 35\text{mm}$ OD X 1.15mm WALL

(See note 6)

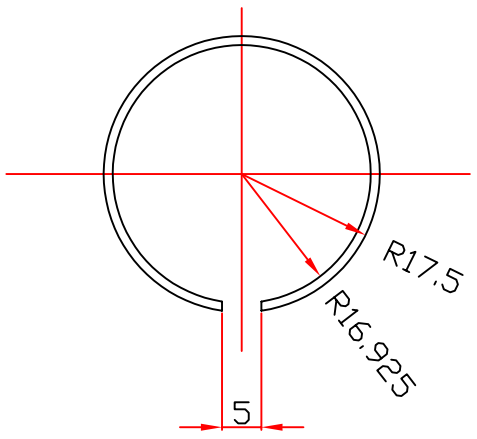
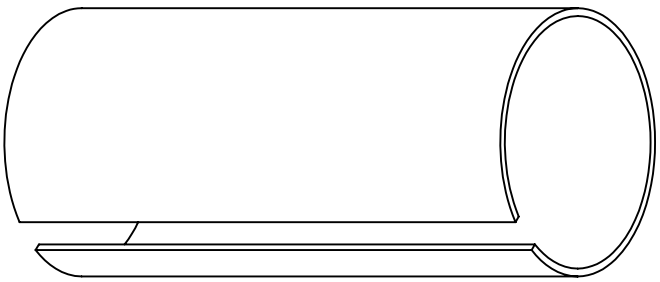

THIRD ANGLE PROJECTION DRAWING PREPARED IN ACCORDANCE TO BS308		GENERAL SURFACE FINISH: μm CLA R _a UNLESS OTHERWISE STATED		DIMENSIONS: mm		TITLE COOLING JACKET CORE		HEAT & SURFACE TREATMENT 16		ALL PROPRIETARY RIGHTS IN THE SUBJECT MATTER HEREOF ARE RESERVED BY SHEFFIELD UNIVERSITY AND NO PERMISSION IS GRANTED TO REPRODUCE THIS PRINT IN WHOLE OR IN PART, OR TO DISCLOSE ANY OF THE INFORMATION UNLESS IT TO OTHERS.	
MATERIAL Copper										UNIVERSITY OF SHEFFIELD DEPARTMENT OF PHYSICS & ASTRONOMY SHEFFIELD S3 7RH Tel: 0114-2223547	
		SCALE: 3:1		DATE: 1/05/08		DRAWN: M. MOHAMMAD		RAL REF: TD-SU-17		DRAWING NUMBER TD-SU-17	
						MM CHK		RN APP.		A4	
						ISSUE DATE		INITIAL ISSUE NOTES			